



preci-dip

WWW.PRECIDIP.COM TEL +41 32 421 04 00 SALES@PRECIDIP.COM

# SPRING-LOADED CONNECTORS

2.54 mm GRID / SINGLE ROW / DOUBLE ROW / SURFACE MOUNT

SPRING-LOADED CONNECTORS

Basic modular connectors with spring-loaded contacts (SLC), surface mount. Contacts with hollow piston design for low profile.

## TECHNICAL SPECIFICATIONS (FOR GENERAL SPECS, SEE PAGE 31)

<b>INSULATOR</b>	Black glass filled polyester PCT-GF30-FR	
<b>FLAMMABILITY</b>	UL 94V-0	
<b>PISTON AND BARREL</b>	Brass CuZn36Pb3 (C36000)	
<b>SPRING</b>	Stainless steel X12 CrNi177, DIN 17224 (Music wire DIN 17223, gold plated for 811...008101)	
<b>MAX. STROKE</b>	1.4 mm (1 mm for 811-...-008101 and 1.15 mm for 811/813-...-001101)	
<b>FORCES</b>	0.25 N initial	0.6 N at 1/2 stroke
<b>MECHANICAL LIFE</b>	100'000 cycles	
<b>OPERATING CURRENT</b>	Max. 3.5 A	
<b>CONTACT RESISTANCE</b>	15 mΩ (static measurement, halfway position)	
<b>COPLANARITY</b>		
<b>SMD TERMINATIONS</b>	Max. 0.1 mm (measured on 25 mm long connectors)	

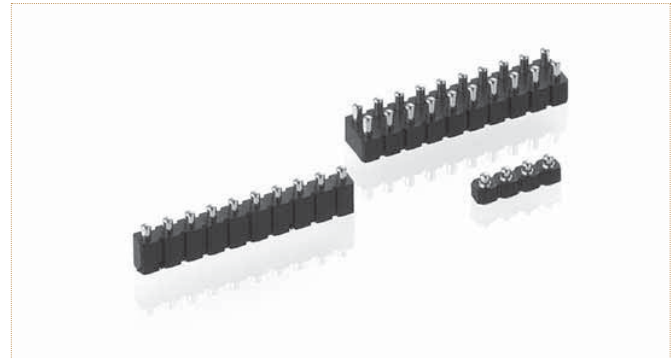

## ORDERING INFORMATION ROHS COMPLIANT PARTS

<b>PLATING CODE</b>	<b>BARREL</b>	<b>PISTON</b>
SS	0.5 μm gold	0.5 μm gold

See page 178 for plating specs.

**NNN number of poles.** Replace **NNN** with the requested number of poles, e.g. 811-SS-**NNN**-30-002101 for a single row version with 16 pins becomes 811-SS-**016**-30-002101.

### Bulk: T & R Packaging with pick & place cap\* :

811-SS-**NNN**-30-008101 811-SS-**NNN**-30-008191

Surface mount SLC connector, very low profile, single row

**AVAILABILITY FROM** 2 to 10 contacts  
(standard number of contacts: 10)

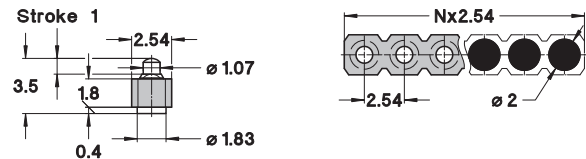

\*Please consult [www.precidip.com](http://www.precidip.com) for availability size of tape, size of reel, number of components per reel and packing units.

### Bulk: T & R Packaging with pick & place cap\* :

811-SS-**NNN**-30-**XXX**101 811-SS-**NNN**-30-**XXX**191

Surface mount SLC connector, low profile, single row

**AVAILABILITY FROM** 2 to 10 contacts  
(standard number of contacts: 10)

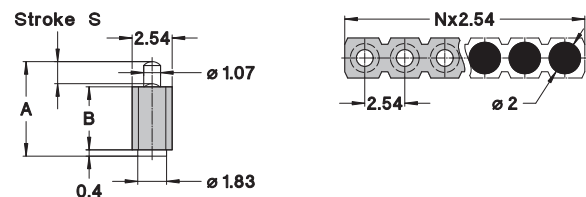

\*Please consult [www.precidip.com](http://www.precidip.com) for availability size of tape, size of reel, number of components per reel and packing units.

### Bulk: T & R Packaging with pick & place cap\* :

813-SS-**NNN**-30-**XXX**101 811-SS-**NNN**-30-**XXX**191

Surface mount SLC connector, low profile, double row

**AVAILABILITY FROM** 4 to 20 contacts  
(standard number of contacts: 20)

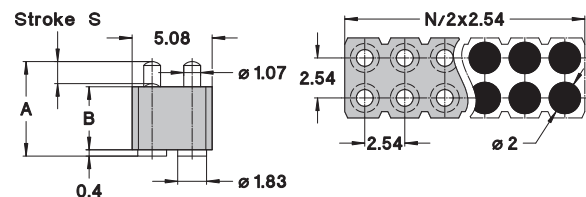

\*Please consult [www.precidip.com](http://www.precidip.com) for availability size of tape, size of reel, number of components per reel and packing units.

## AVAILABLE CONNECTOR HEIGHTS

INITIAL HEIGHT A (mm)	STROKE S (mm)	PLASTIC BODY HEIGHT B (mm)	XXX CODE
4.5	1.15	2.95	001
5	1.4	2.95	002
5.5	1.4	2.95	003
6	1.4	4	004
6.5	1.4	4	005
7	1.4	4	006
7.5	1.4	4	007

# Mouser Electronics

Authorized Distributor

Click to View Pricing, Inventory, Delivery & Lifecycle Information:

## Preci-dip:

[811-S1-004-30-015191](#) [811-SS-008-30-008191](#) [811-SS-010-30-008191](#) [811-S1-010-30-014191](#) [811-S1-009-30-014191](#) [811-S1-008-30-014191](#) [811-S1-007-30-014191](#) [811-S1-006-30-014191](#) [811-S1-005-30-014191](#) [811-S1-003-30-014191](#) [811-S1-002-30-014191](#) [811-SS-007-30-008191](#) [811-SS-006-30-004191](#) [811-SS-008-30-005191](#) [811-SS-007-30-005191](#) [811-SS-006-30-005191](#) [811-SS-005-30-005191](#) [811-SS-004-30-005191](#) [811-SS-003-30-005191](#) [811-SS-002-30-005191](#) [811-SS-010-30-004191](#) [811-SS-009-30-004191](#) [811-SS-009-30-008191](#) [811-SS-007-30-004191](#) [811-SS-002-30-006191](#) [811-SS-005-30-004191](#) [811-SS-004-30-004191](#) [811-SS-003-30-004191](#) [811-SS-002-30-004191](#) [811-SS-010-30-003191](#) [811-SS-009-30-003191](#) [811-SS-008-30-003191](#) [811-SS-007-30-003191](#) [811-SS-006-30-003191](#) [811-SS-005-30-003191](#) [811-SS-008-30-004191](#) [811-SS-003-30-007191](#) [811-SS-006-30-008191](#) [811-SS-005-30-008191](#) [811-SS-004-30-008191](#) [811-SS-003-30-008191](#) [811-SS-002-30-008191](#) [811-SS-010-30-007191](#) [811-SS-009-30-007191](#) [811-SS-008-30-007191](#) [811-SS-007-30-007191](#) [811-SS-006-30-007191](#) [811-SS-009-30-005191](#) [811-SS-004-30-007191](#) [811-SS-010-30-005191](#) [811-SS-002-30-007191](#) [811-SS-010-30-006191](#) [811-SS-009-30-006191](#) [811-SS-008-30-006191](#) [811-SS-007-30-006191](#) [811-SS-006-30-006191](#) [811-SS-005-30-006191](#) [811-SS-004-30-006191](#) [811-SS-003-30-006191](#) [811-SS-005-30-007191](#) [811-S1-005-30-016191](#) [811-S1-007-30-017191](#) [811-S1-006-30-017191](#) [811-S1-005-30-017191](#) [811-S1-004-30-017191](#) [811-S1-003-30-017191](#) [811-S1-002-30-017191](#) [811-S1-010-30-016191](#) [811-S1-008-30-016191](#) [811-S1-009-30-017191](#) [811-S1-006-30-016191](#) [811-S1-010-30-017191](#) [811-S1-003-30-016191](#) [811-S1-002-30-016191](#) [811-S1-010-30-015191](#) [811-S1-009-30-015191](#) [811-S1-008-30-015191](#) [811-S1-007-30-015191](#) [811-S1-006-30-015191](#) [811-S1-005-30-015191](#) [811-SS-002-30-003191](#) [811-S1-007-30-016191](#) [811-S1-003-30-015191](#) [811-S1-008-30-017191](#) [811-SS-004-30-003191](#) [811-SS-008-30-001191](#) [811-SS-010-30-002191](#) [811-SS-009-30-002191](#) [811-SS-008-30-002191](#) [811-SS-007-30-002191](#) [811-SS-006-30-002191](#) [811-SS-005-30-002191](#) [811-SS-004-30-002191](#) [811-SS-003-30-002191](#) [811-SS-002-30-002191](#) [811-SS-009-30-001191](#) [811-SS-007-30-001191](#) [811-SS-006-30-001191](#) [811-SS-005-30-001191](#) [811-SS-004-30-001191](#)